

RoHS Compliant

Rev.	change details	effective date	updated by	date
A	Initial release	2020.12.19	FHY	20.12.19

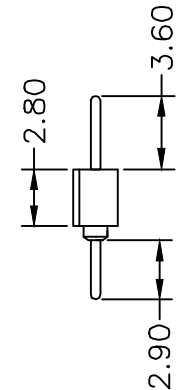
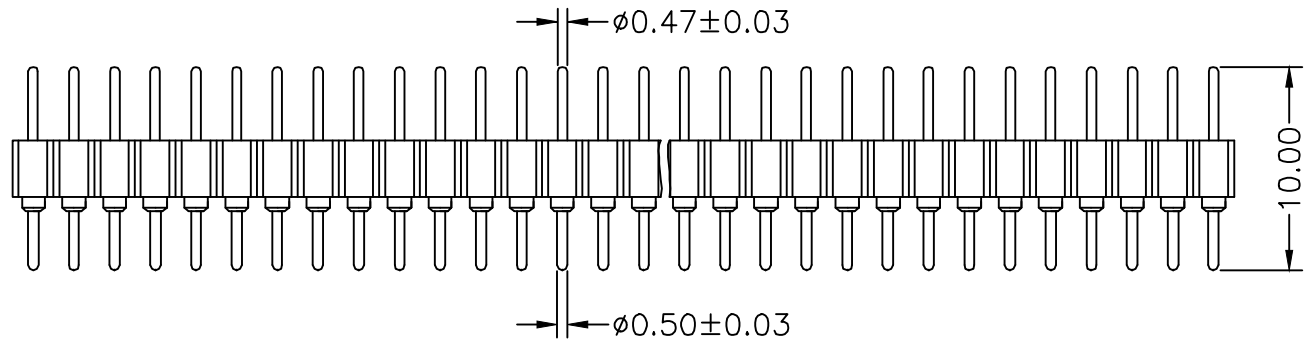
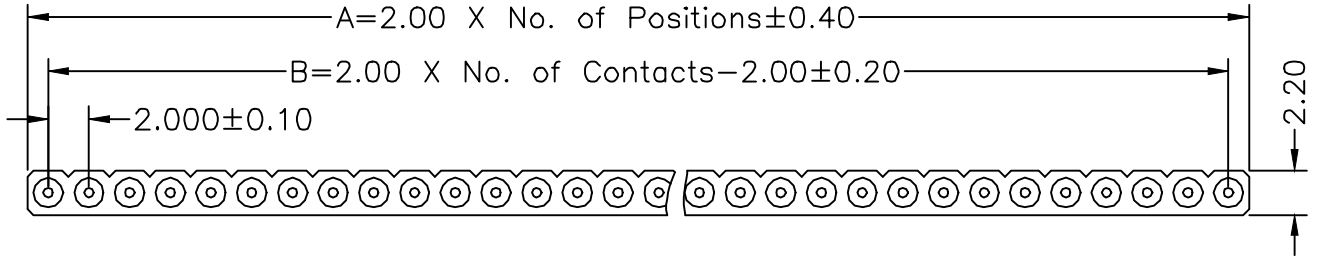

Std. Material
 Pin(outer sleeve): Brass machined CuZn38Pb2
 Plating(outer sleeve):
 Tin Plated: $2\mu\text{m}/80\text{u}''\text{Ni}; 5\mu\text{m}/200\text{u}''\text{Sn}$
 Gold Plated: $2\mu\text{m}/80\text{u}''\text{Ni}; \text{Full Gold}$
 Insulator(Black):
 Glass filled thermal Plastic Polyester (UL94V-0).
Temperature
 Operating Temp.: -40°C to 105°C
 Max. Processing Temp.: 260°C for 10s
Electrical Specifications
 Current Rating : 3 AMP
 Contact Resistance : 20mΩ Max.
 Insulation Resistance : 1000MΩ Min.
 Withstanding Voltage : AC 1000V for 60s
Packing : Tray or agree on _____

Ordering Information

No. of Pins	Contact Plating	Insulator Material
Rows*Pins 1 x 40	SN: Tin <input type="checkbox"/> G0: 0.8u'' Gold <input type="checkbox"/> G1: 1u'' Gold <input type="checkbox"/> G2: 1.5u'' Gold <input type="checkbox"/> G3: 2u'' Gold <input type="checkbox"/> G4: 3u'' Gold <input type="checkbox"/> G5: __u'' Gold <input type="checkbox"/>	A: PBT <input type="checkbox"/> B: PA6T <input type="checkbox"/> C: PA9T <input type="checkbox"/> D: PA66 <input type="checkbox"/> E: PA46 <input type="checkbox"/> F: LCP <input type="checkbox"/> G: _____ <input type="checkbox"/>
Ordering:(N) 1 X <input type="checkbox"/>		

Ordering Dimensions

A	B	C	D	H	W
PA	PB	PC	PD	PW	L

Remarks:

UNLESS OTHERWISE STATED DIMENSIONS IN mm TOLERANCE:	ORIGINALLY BY	
	DRAWN: FHY	
	CHECKED: FY	
	APPROVED: FY	
DATE: 2020.12.19		
ANGULAR $\pm 1^\circ$	LINEAR X 0.5 X.X ± 0.2 X.XX ± 0.1	发现更多

深圳市征华电子有限公司
 Shenzhen ZWON Electronics Co.,Ltd.
 SERIES: Round PH2.0*2.0/Single Row/Straight
 TYPICAL MODEL: 2.00mm圆孔排针 单排 180度 L=10.0

Drawing No.	DRXXX-XX	
Scale	Revision	Sheet
FIT	A	1 of 1
ZWON P/N:		
Customer P/N:		