

RoHS Compliant

| Rev. | change details | effective date | updated by | date |
|------|-----------------|----------------|------------|----------|
| A | Initial release | 2020.12.19 | FHY | 20.12.19 |

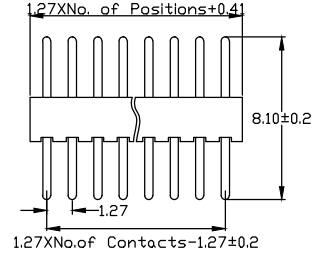

Straight socket connector:solder tail
single row
Availability from:2 to 50 contacts
Standard number of contacts 25 and 50

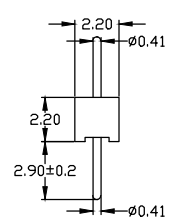
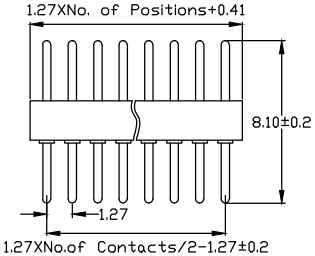
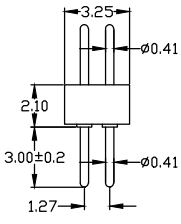

Straight socket connector:solder tail
double row
Availability from:4 to 100 contacts
Standard number of contacts 50 and 100

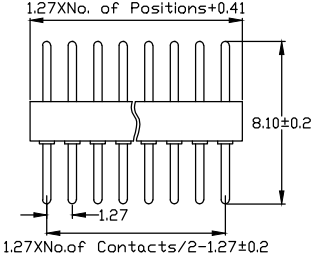
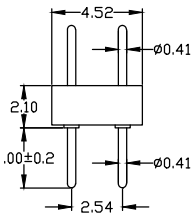

Straight socket connector:solder tail
double row with 2.54mm rowto row distance
Availability from:4 to 100 contacts
Standard number of contacts 100

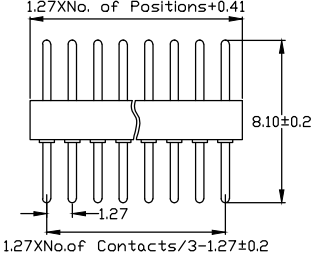
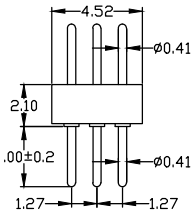

Straight socket connector:solder tail
triple row
Availability from:6 to 150 contacts
Standard number of contacts 150

Std. Material
Insulator:Black glass filled polyester PPS-GF30-FR

Flammability : UL94V-0
Sleeve : Brass CuZn 36Pb3(36000)
Mating pin ϕ : 0.41 mm
Mechanical life : min 500 cycles
Rated current : 1Amp
Contact resistance: Max 10m Ω
Dielectric resistance : Min 1000V RMS

Temperature
Operating Temp. : -40 $^{\circ}$ C to 105 $^{\circ}$ C
Max. Processing Temp.: 260 $^{\circ}$ C for 10s
Packing : PE bag or agree on_____

Ordering Information

| No. of Pins | Contact Plating | Insulator Material |
|------------------------------|---|-----------------------------------|
| Rows*Pins | SN: Tin <input type="checkbox"/> | A: PBT <input type="checkbox"/> |
| 1/2/3 x 50 | G0: 0.8u" Gold <input type="checkbox"/> | B: PA6T <input type="checkbox"/> |
| | G1: 1u" Gold <input type="checkbox"/> | C: PA9T <input type="checkbox"/> |
| Ordering:(N) | G2: 1.5u" Gold <input type="checkbox"/> | D: PA66 <input type="checkbox"/> |
| 1/2/3 x <input type="text"/> | G3: 2u" Gold <input type="checkbox"/> | E: PA46 <input type="checkbox"/> |
| | G4: 3u" Gold <input type="checkbox"/> | F: LCP <input type="checkbox"/> |
| | G5: ___u" Gold <input type="checkbox"/> | G: _____ <input type="checkbox"/> |

Ordering Dimensions

| A | B | C | D | H | W |
|----|----|----|----|----|---|
| PA | PB | PC | PD | PW | L |

Remarks:

| | | |
|---|---|------|
| UNLESS OTHERWISE STATED DIMENSIONS IN mm TOLERANCE: | ORIGINALLY BY | |
| | DRAWN: FHY | |
| | CHECKED: FY | |
| | APPROVED: FY | |
| DATE:2020.12.19 | | 发现更多 |
| ANGLEAR $\pm 1^{\circ}$ | LINEAR X 0.5 X.X ± 0.2 X.XX ± 0.1 | 扫描官网 |

深圳市征华电子有限公司
Shenzhen ZWON Electronics Co.,Ltd.

SERIES: Round PH1.27/Straight L=8.1

TYPICAL MODEL: 1.27圆孔排针 180度 L=8.1

| | | |
|---------------|----------|--------|
| Drawing No. | DRXXX-XX | |
| Scale | Revision | Sheet |
| FIT | A | 1 of 1 |
| ZWON P/N: | | |
| Customer P/N: | | |